



PTZ Camera

INSTALLATION GUIDE

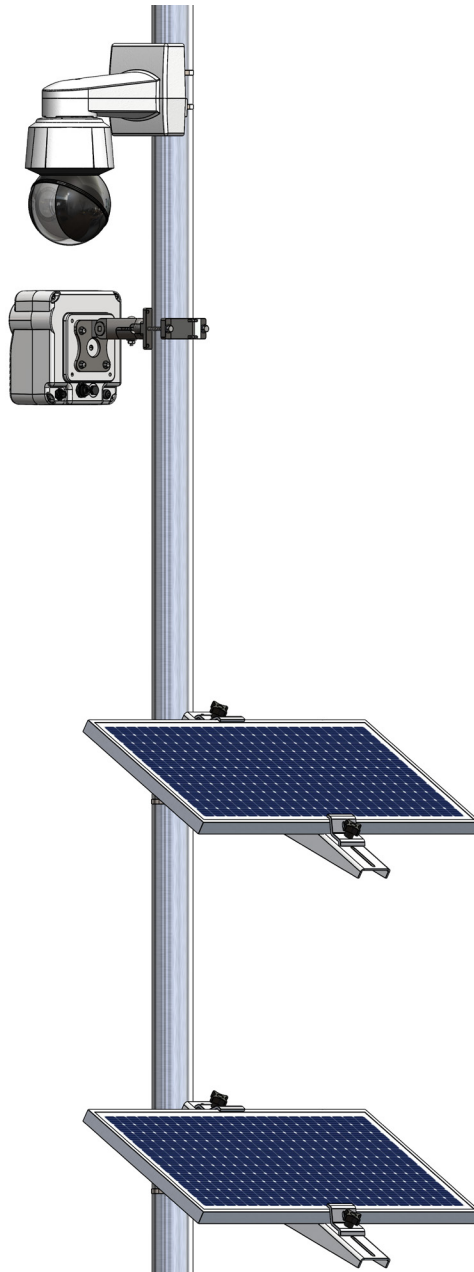

TABLE OF CONTENTS

Installation Overview 3

Reference. 4

Step 1: PTZ Camera Installation 6

Step 2: CPU Installation 13

Step 3: Solar Panel Installation 19

Step 4: Cable Connections & Configuration 25

Final Checklist. 26

Don't want to use paper instructions? Scan the QR code!



INSTALLATION OVERVIEW

BEFORE YOU BEGIN

- Expect each camera installation to take approximately 45 mins
- Two people recommended
- Make note of each camera serial number (*bottom of CPU*) and installation location for later reference
- Please note the layout of the subsystems - the solar panels should be mounted underneath the camera and CPU
- Use the Site Plan provided by your Sensera Systems representative to ensure your camera is placed in the correct location

TOOLS REQUIRED

- **Drill** - recommended for use with 7mm Nut Driver (D)
- **No. 2 Phillips head screwdriver** - for band clamps (C)
- *Optional* - ½" Nut Driver for Camera Arm hardware (B)
- *Optional* - Smart device for SenserAlign app
- *Optional* - T30 drill bit (only if using drill)

WHAT'S INCLUDED

- **A:** CPU
- **B1-5:** CPU Arm
- **C:** Band Clamps*
- **D:** 7mm Nut Driver*
- **E1:** Main Solar Panel
- **E2:** Auxiliary Solar Panel
- **F1-3:** Solar Panel Arms
- **G:** Wrench (½" Hex)
- **H:** Wood Screws*
- **J:** Large Washers for Wood Screws*
- **K:** Indoor AC Power Adapter**
- **L:** Lens Wipe for Camera Window
- **O:** Outdoor AC Adapter
- **P:** PTZ Camera
- **Q1-3:** PTZ Wall-and-Pole Mount
- **R:** T30 L-Key

**Note that some items may not be used depending on your installation solution.*

***Indoor AC Power Adapter for indoor use **only**. Store the adapter for offline camera charging and troubleshooting.*

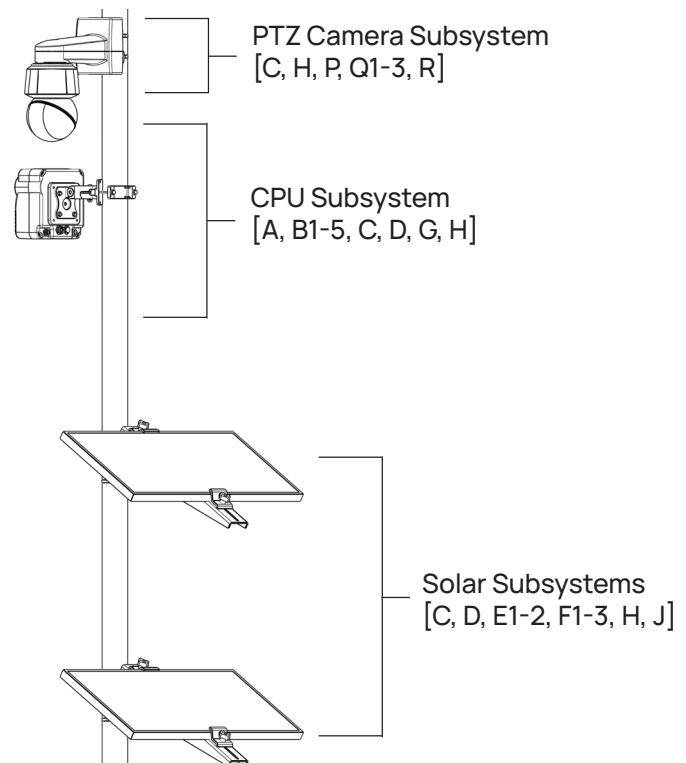

REFERENCE: USING THE BAND CLAMPS

Sensera Systems cameras come with quick eject band clamps for easy installation and adjustment.

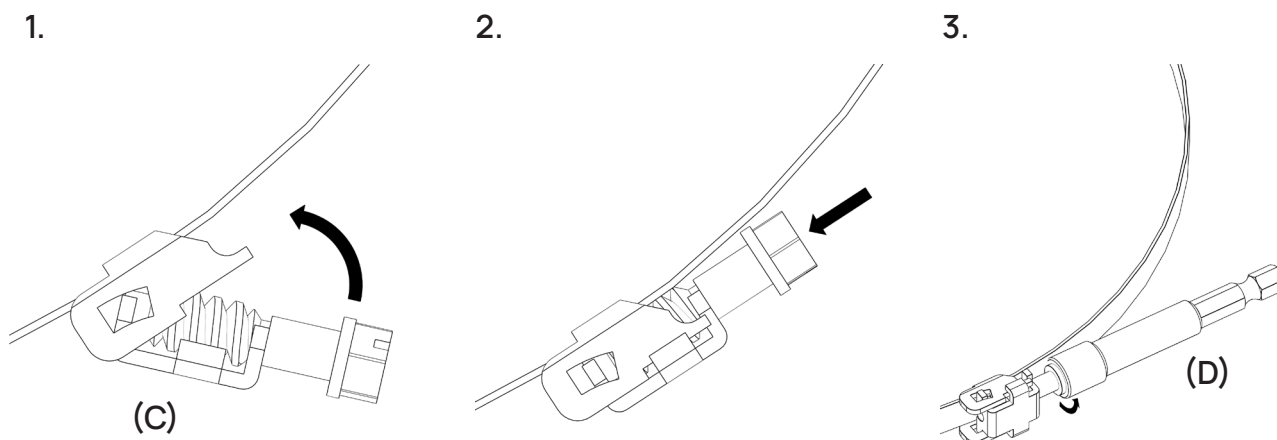

The band clamps **(C)** can be tightened/loosened with the included nut driver **(D)** and a drill, OR a Phillips head screwdriver.

REFERENCE: OUTDOOR AC POWER ADAPTER

The Outdoor AC Power Adapter can be used with an outdoor rated outlet to provide continuous power to the camera.

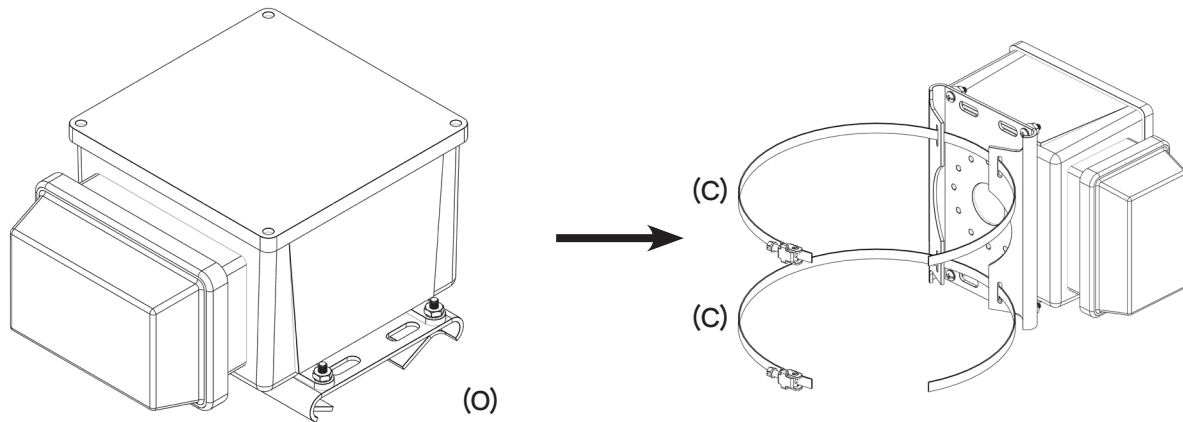

 Use punch out holes to route outlet cord and seal clear lid.

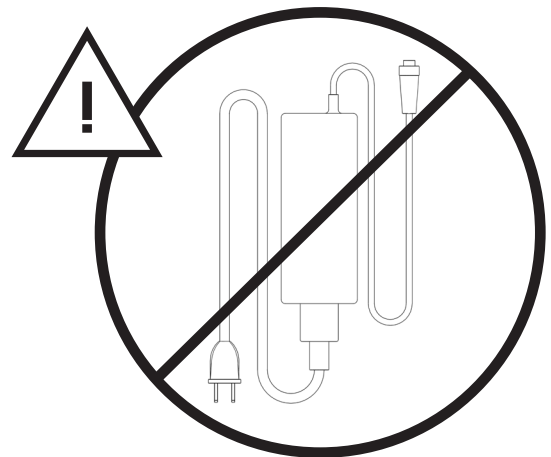

Do NOT use indoor AC
adapter outdoors

STEP 1: PTZ CAMERA INSTALLATION

WARNING: Do not connect the PTZ camera to power until installed. Connecting your PTZ camera to power before installation may damage the unit.

ITEMS REQUIRED

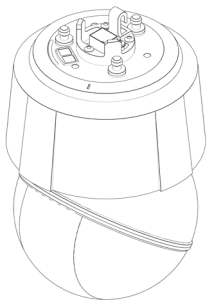

PTZ Camera
(P)

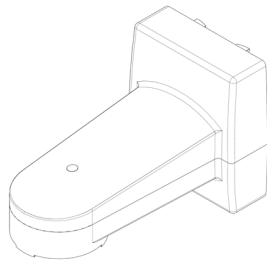

PTZ Wall-and-Pole Mount
(Q1-3)

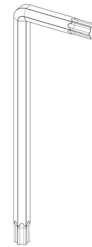

T30 L-Key
(R)

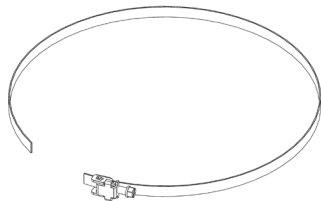

2x Band Clamp
(C)



7mm Nut Driver
(D)

Other Tools (Not Included):

- Drill for 7mm Nut Driver
- Phillips head screwdriver
- T30 Drill Bit
- *Optional* Hardware for wall mount

CAMERA PLACEMENT REQUIREMENTS

- **Site Plan:** Follow the included Site Plan for camera placement
- **Accessibility:** The camera should be easily accessible for maintenance

1A: INSTALL Q1 TO WALL OR POLE

Select **ONE** of the following two options.

OPTION 1: WALL MOUNTING

(Q1)

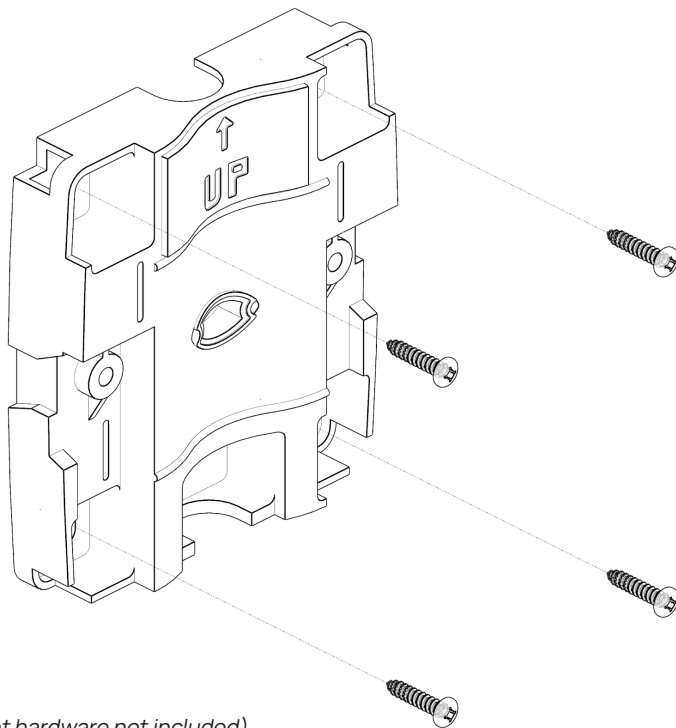

(Wall mount hardware not included)

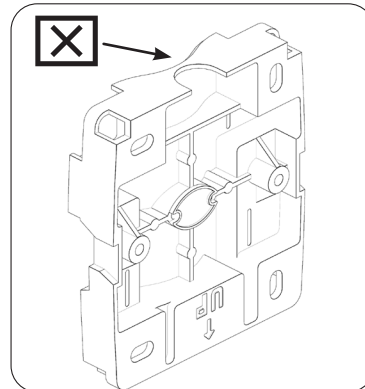
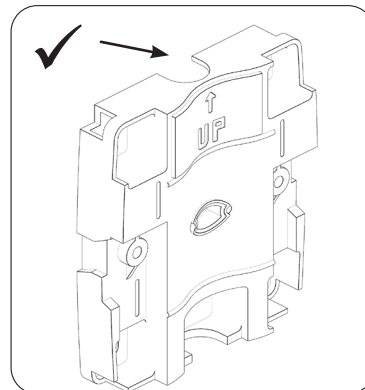

OPTION 2: POLE MOUNTING

(Q1)

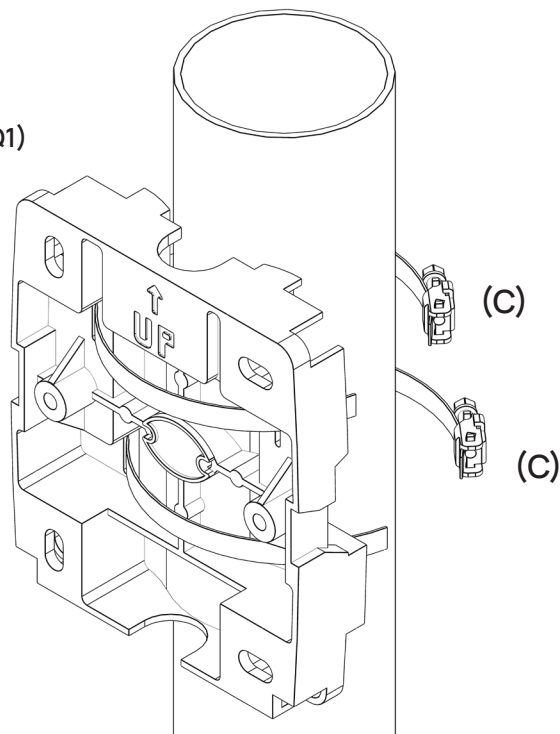

(See page 4 on how to use band clamps (C))

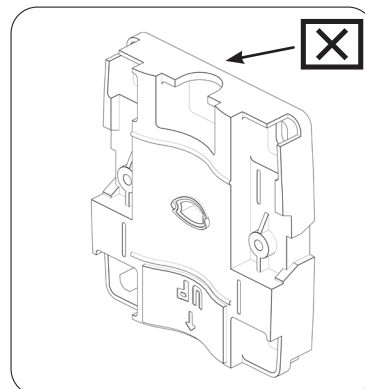
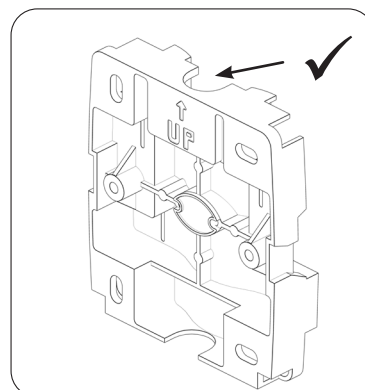

1B: SEPARATE Q3 FROM Q2

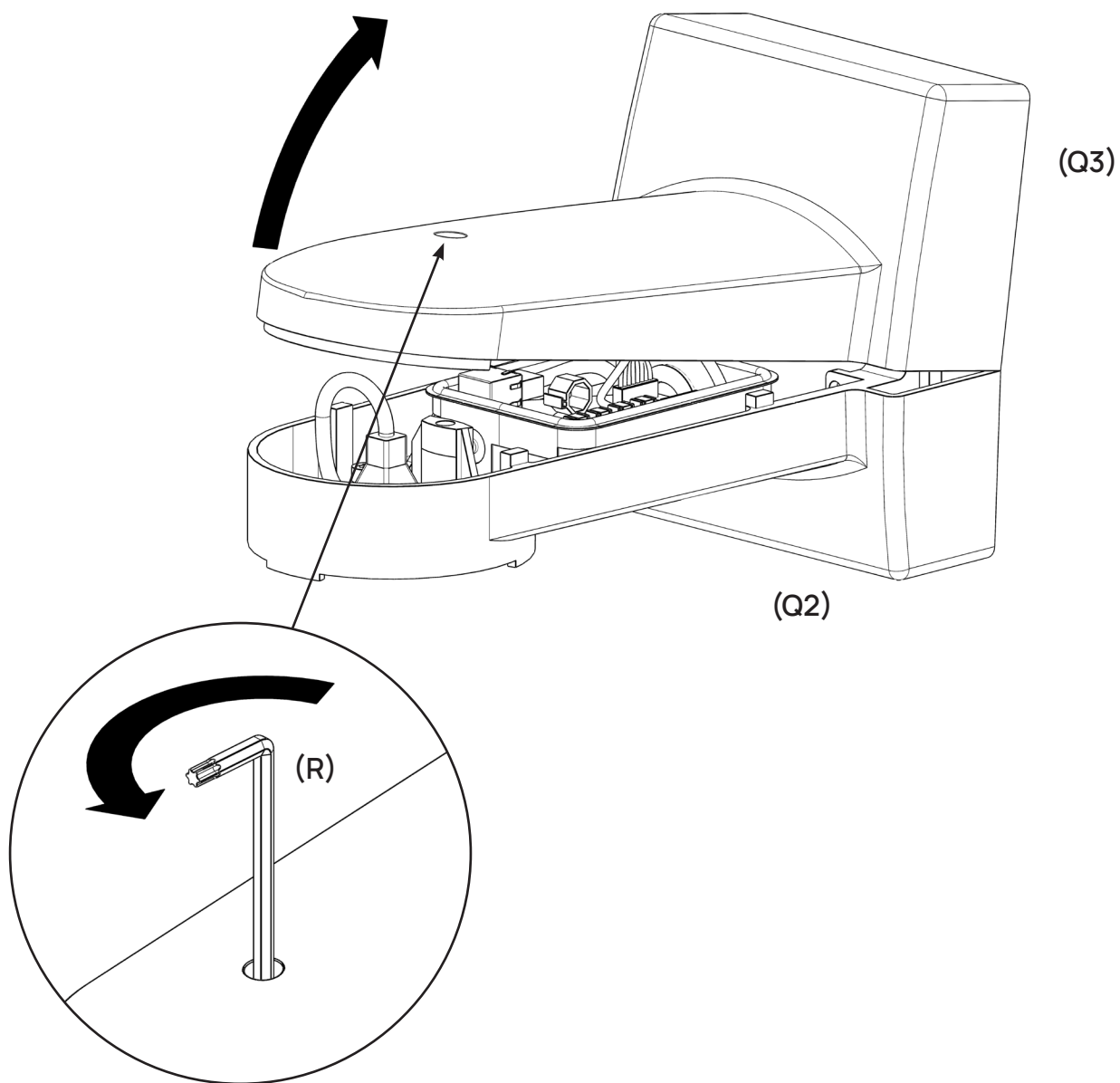

1D: ATTACH Q2 TO Q1

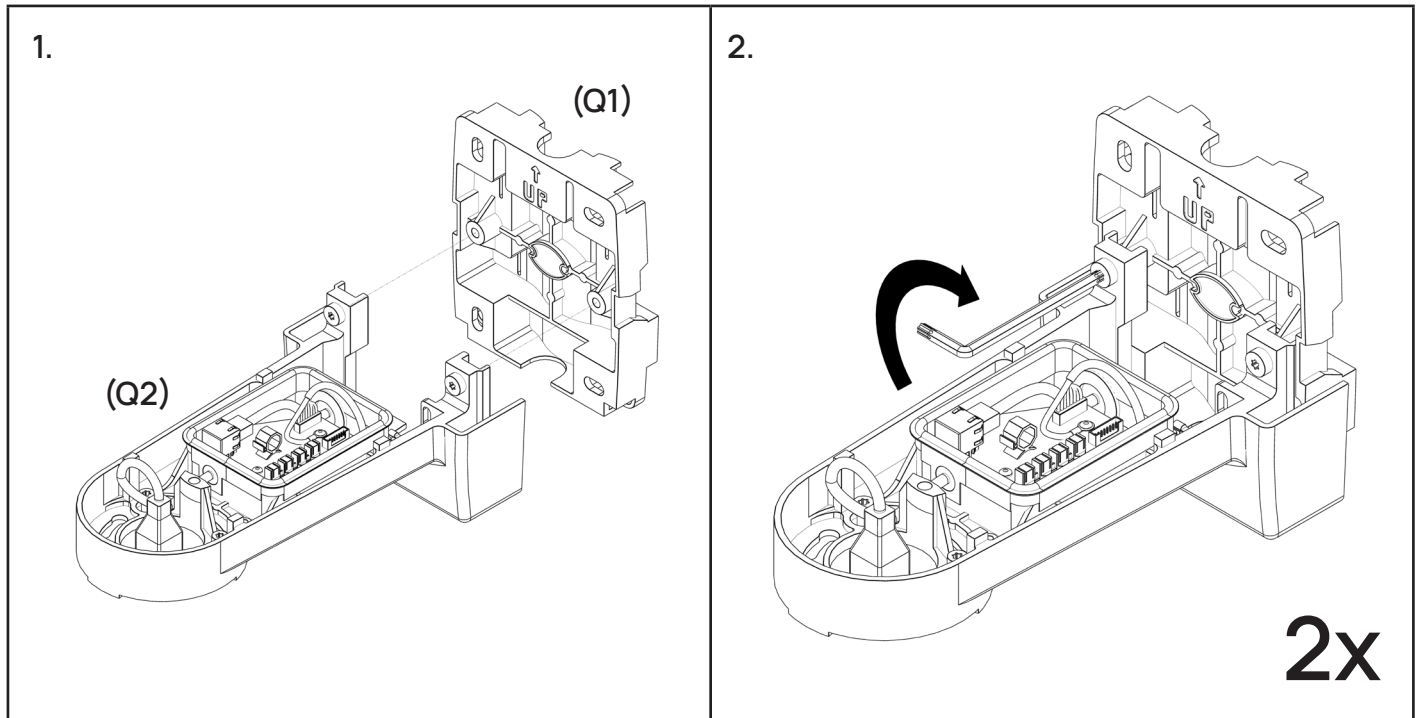

1D: ATTACH THE PTZ CAMERA

1.

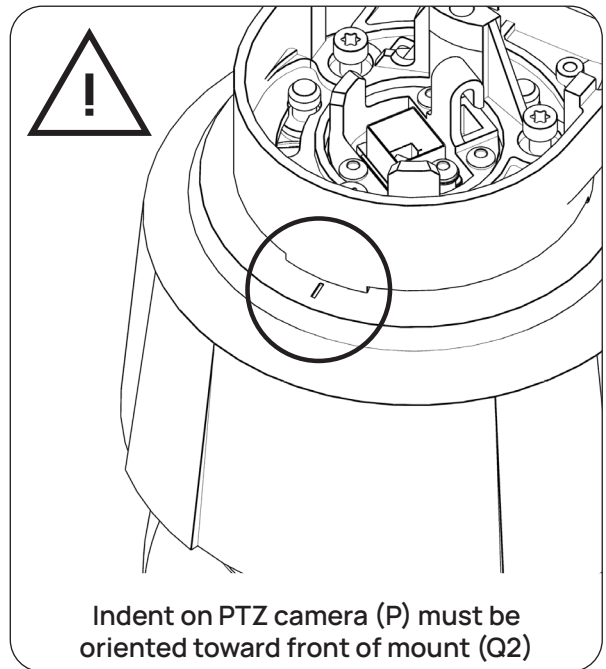
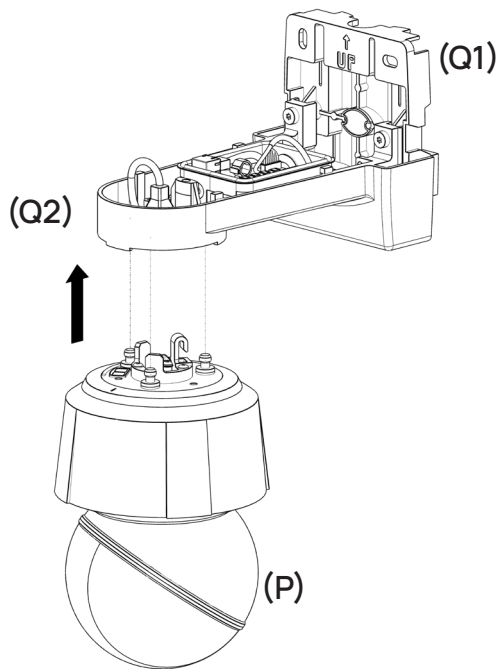

2.

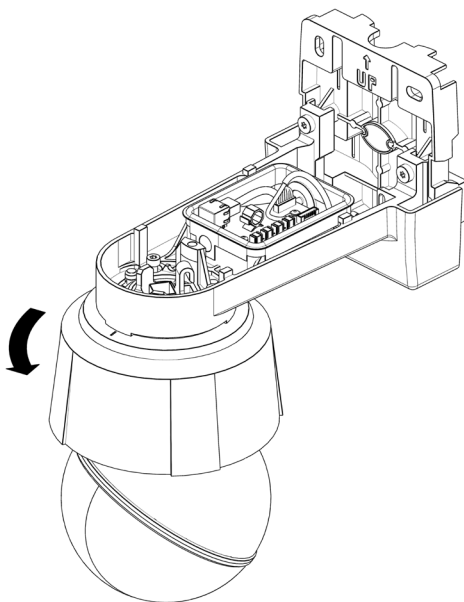

3.

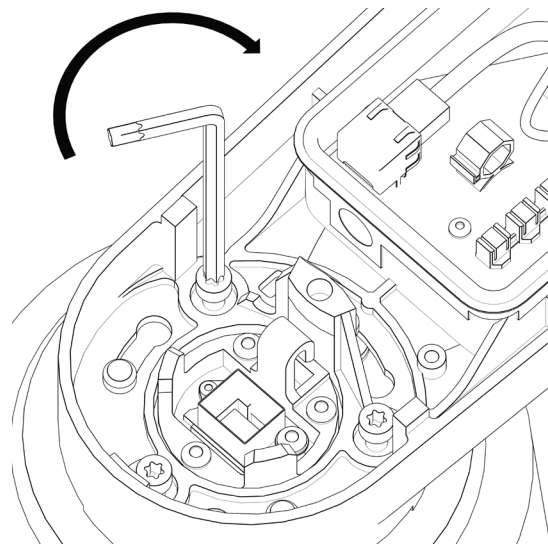

3x

1E: CONNECT THE PTZ CAMERA

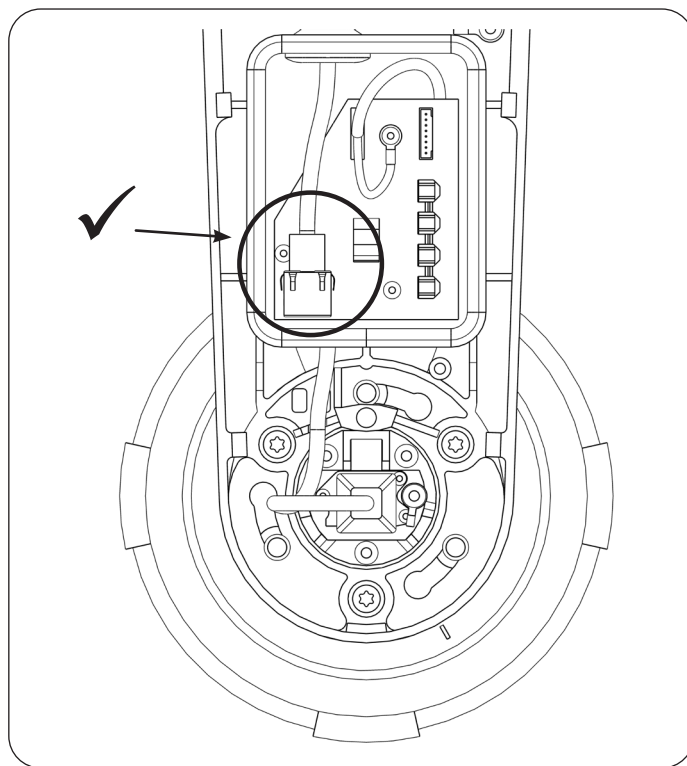
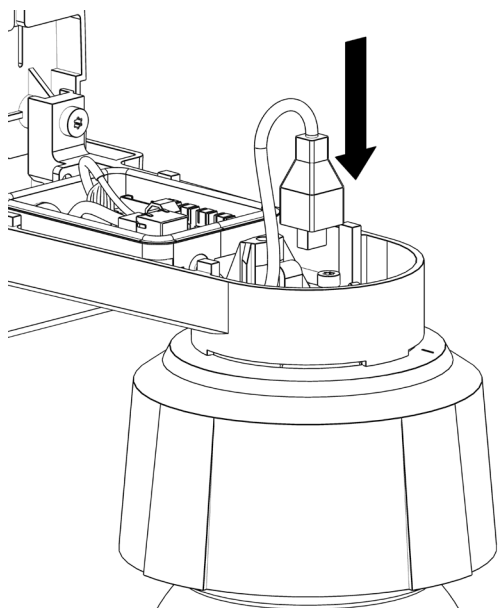

NOTE: Failure to tightly fasten all PTZ camera connections will render the PTZ camera non-functional.

1F: ATTACH Q3 TO Q2

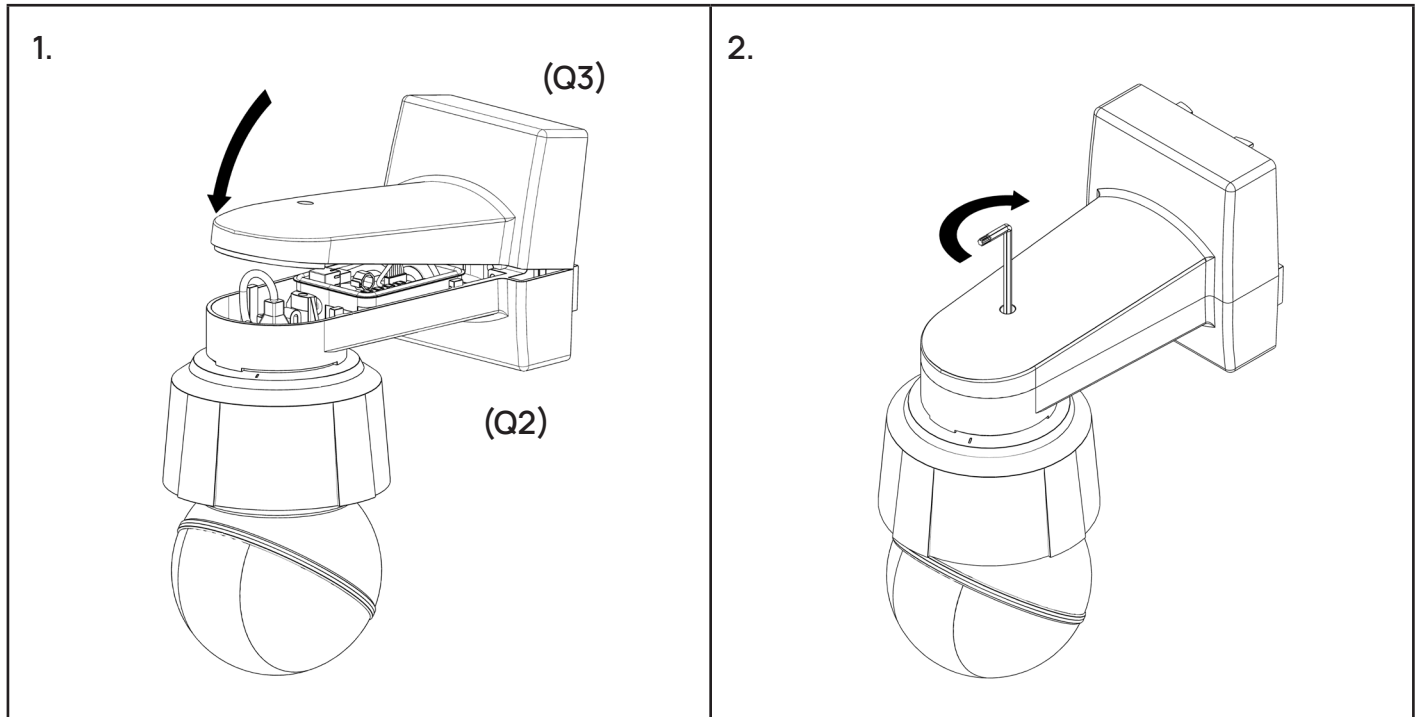

STEP 2: CPU INSTALLATION

ITEMS REQUIRED

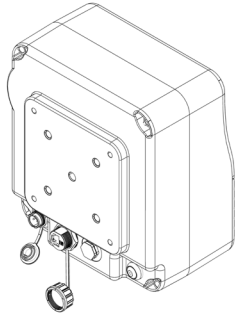

CPU
(A)

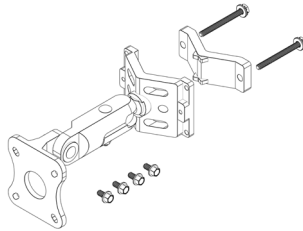

CPU Arm
(B1-5)

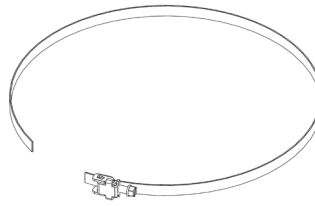

2x Band Clamp
(C)



7mm Nut Driver
(D)

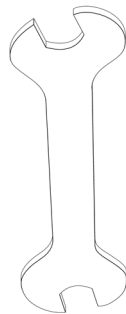

Wrench
(G)

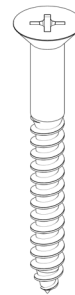

4x Wood Screw *
(H)

**Wood Screw for use with wooden post/wall*

Other Tools (Not Included):

- Drill for 7mm Nut Driver
- Phillips head screwdriver

CAMERA PLACEMENT REQUIREMENTS

- **Site Plan:** Follow the included Site Plan for camera placement
- **Accessibility:** The camera should be easily accessible for maintenance

2A: REMOVE THE HINGE FROM THE CPU ARM AND ATTACH TO THE BACK OF THE CPU

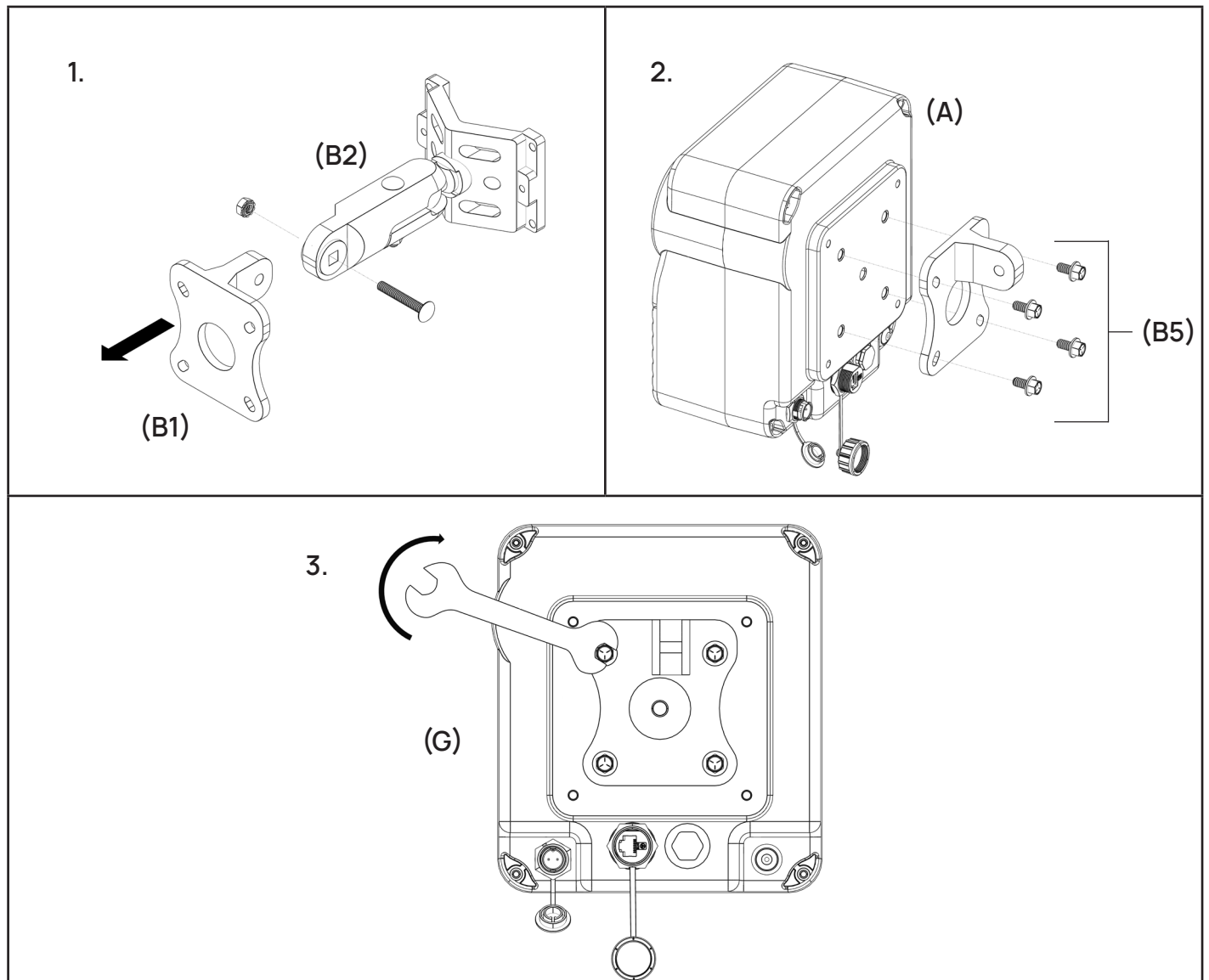

2B: MOUNT THE CPU ARM

Select **ONE** of the following four options corresponding to your mounting solution.

OPTION 1: WOODEN POST / FLAT SURFACE

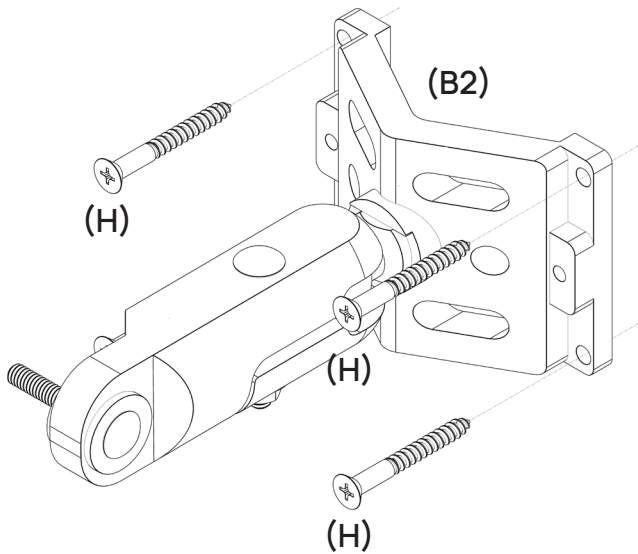

OPTION 2: SMALL DIAMETER POLE (<1.75")

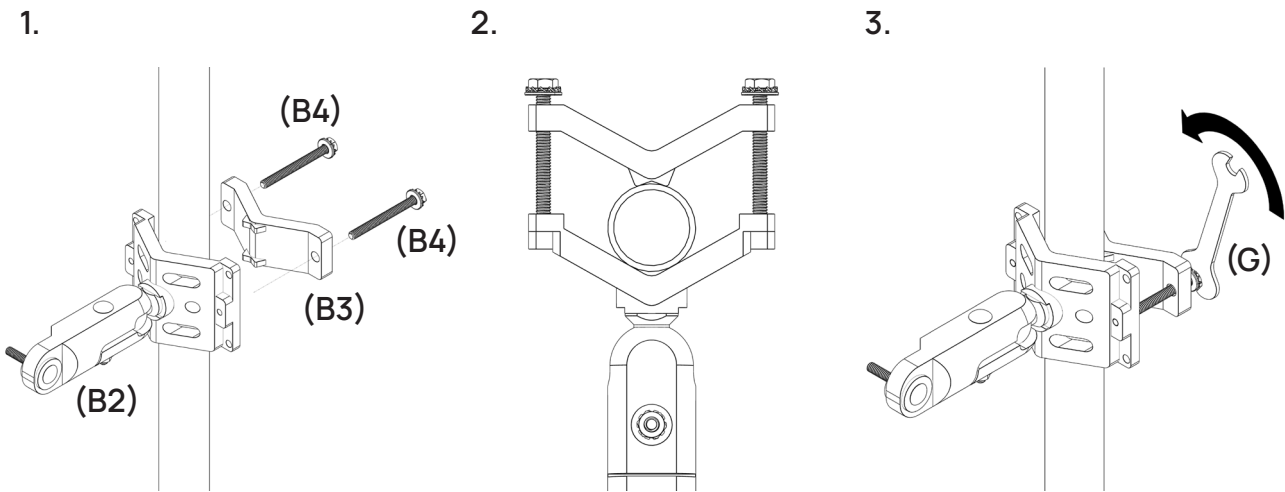

1"

2"

3"

4"

5"

6"

7"

8"

9"

10"

OPTION 3: MEDIUM DIAMETER POLE (1.75" - 3")

1.

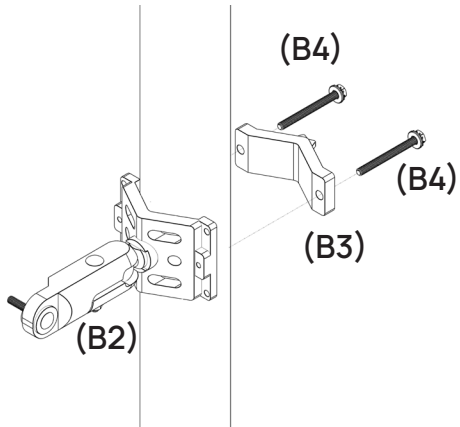

2.

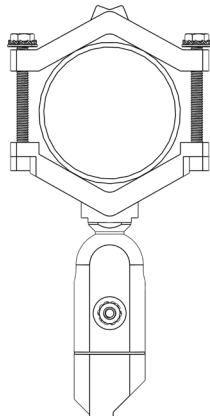

3.

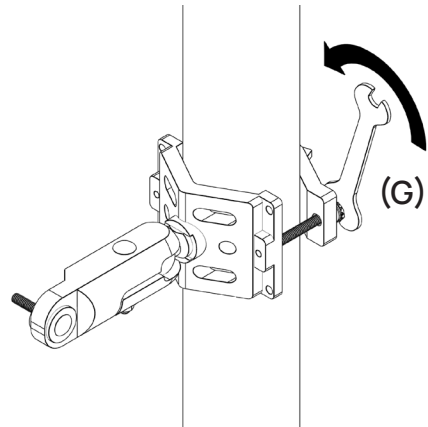

OPTION 4: LARGE DIAMETER POLE (>3")

1.

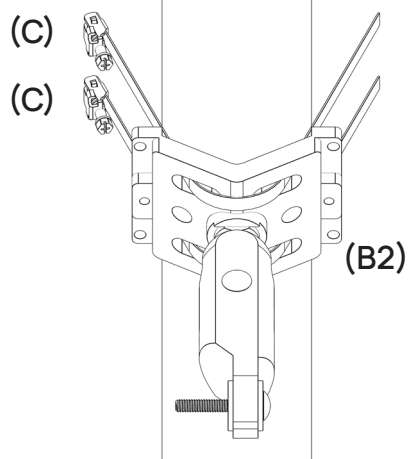

2.

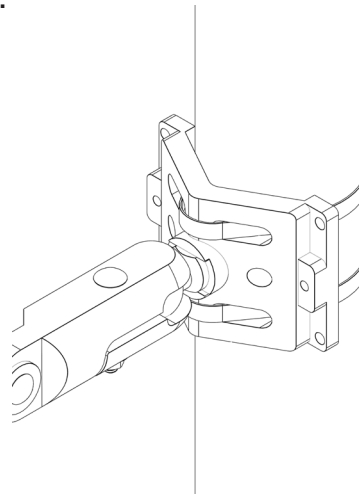

(See page 4 on how to use band clamps (C))

2C: ATTACH THE CPU TO THE CPU ARM

CAUTION: CPU will be loose on arm until screws are tightened as shown on the following page.

1.

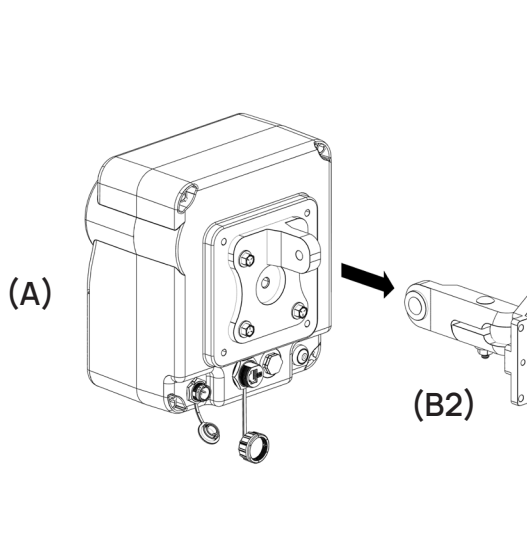

2.

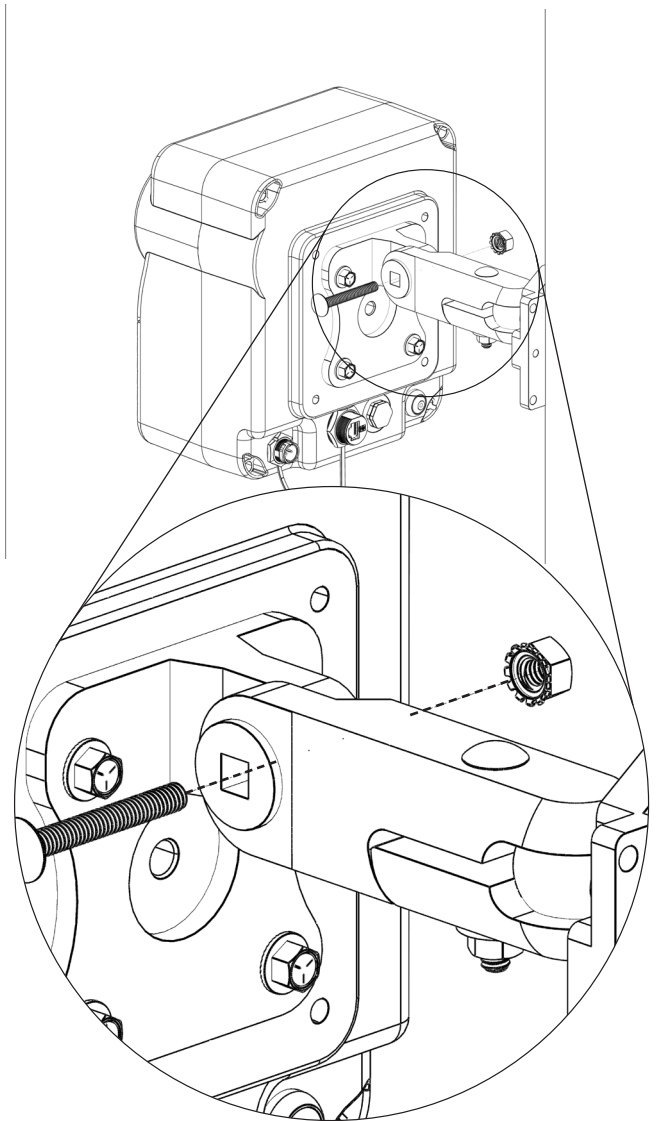

2D: FASTEN THE CPU

Tighten the screws at the two points show below.

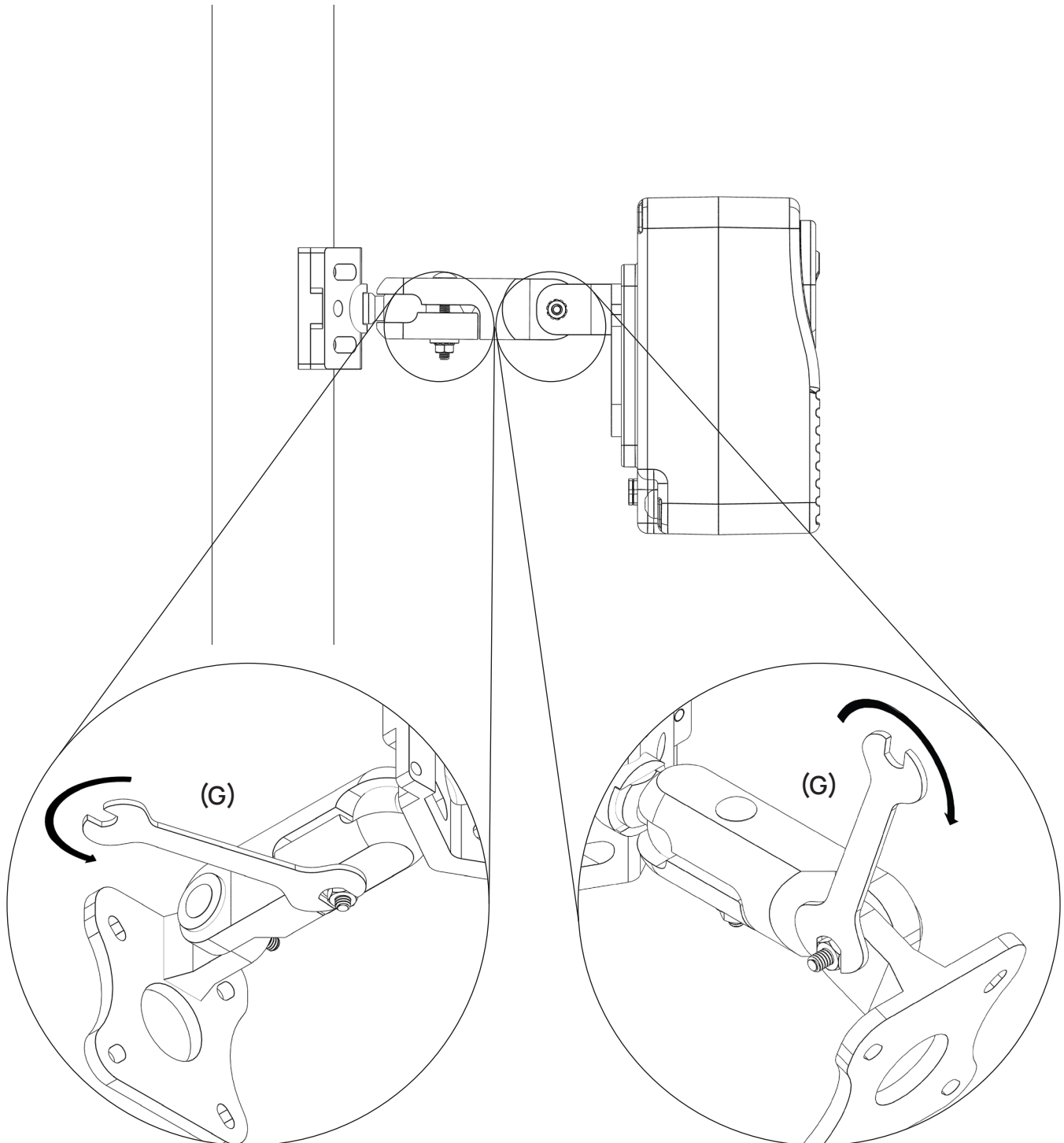

STEP 3: SOLAR PANEL INSTALLATION

ITEMS REQUIRED

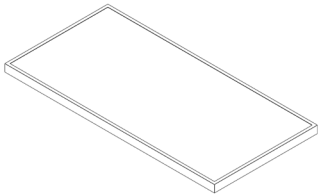

Main Solar Panel
(single cable)
(E1)

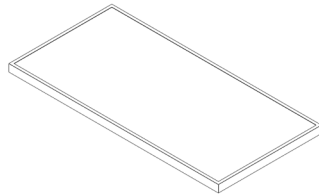

Auxiliary Solar Panel
(double cables)
(E2)

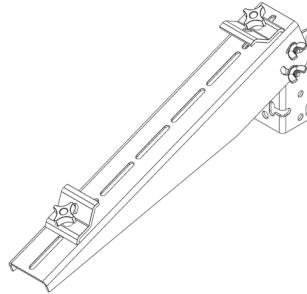

2x Solar Panel Arm
and Hardware
(F1-3)

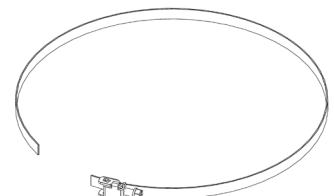

4x Band Clamp
(C)



7mm Nut Driver
(D)

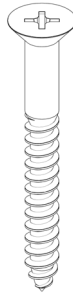

4x Wood Screw*
(H)

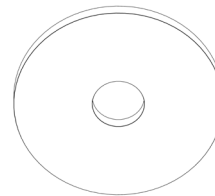

4x Large Washer*
(J)

**Wood Screw and Washer for use with wooden post/wall*

Other Tools (Not Included):

- Drill for 7mm Nut Driver
- Phillips head screwdriver
- Smart device for SenserAlign App

3A: POSITION THE SOLAR PANELS

POSITIONING REQUIREMENTS

- For poles/masts, place your panels below the cameras and accessories, as low to the ground as cable length will allow for.
- Place the auxiliary panel (double cables) above the main solar panel (single cable).
- Make sure the uppermost solar panels do not shade or obstruct the lowermost solar panels.

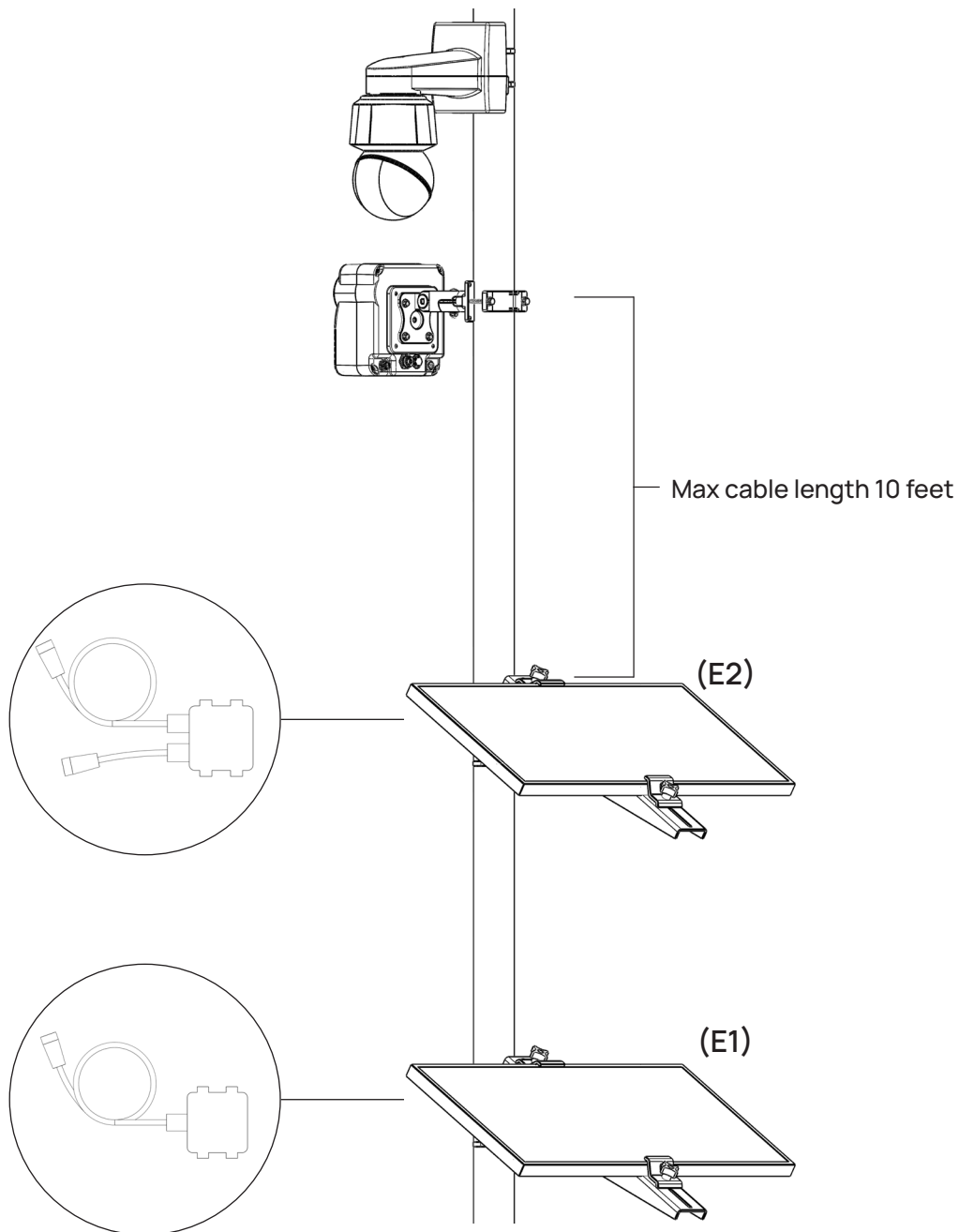

NOTE: Both solar panels should face the same direction and should be set at the same angle

3B: MOUNT THE SOLAR ARMS

Select **ONE** of the following three options corresponding to your mounting solution.

OPTION 1: WOODEN POST / FLAT SURFACE

1.

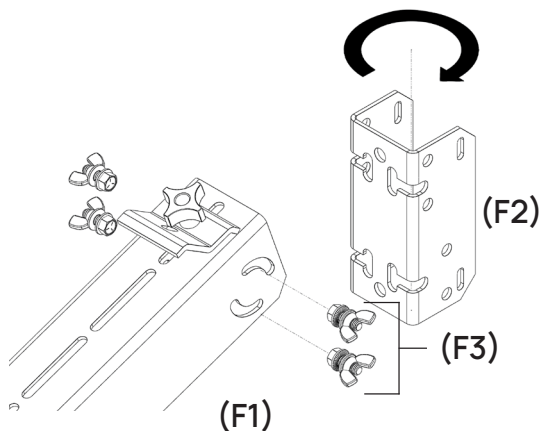

Disassemble the arm, reverse F2, and reassemble.

2.

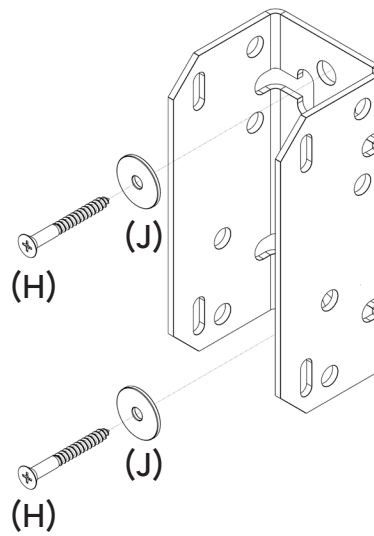

1" _____
2" _____
3" _____
4" _____
5" _____
6" _____
7" _____
8" _____
9" _____
10" _____

OPTION 2: FOR SMALL DIAMETER POLE (<2.75")

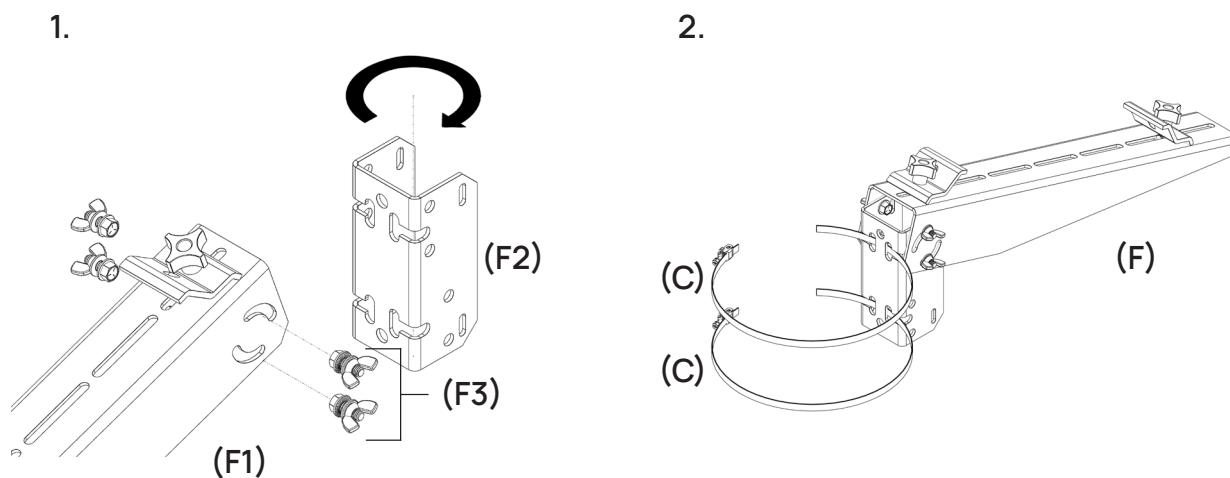

Disassemble the arm, reverse F2, and reassemble.

(See page 4 on how to use band clamps (C))

OPTION 3: FOR LARGE DIAMETER POLE (>2.75")

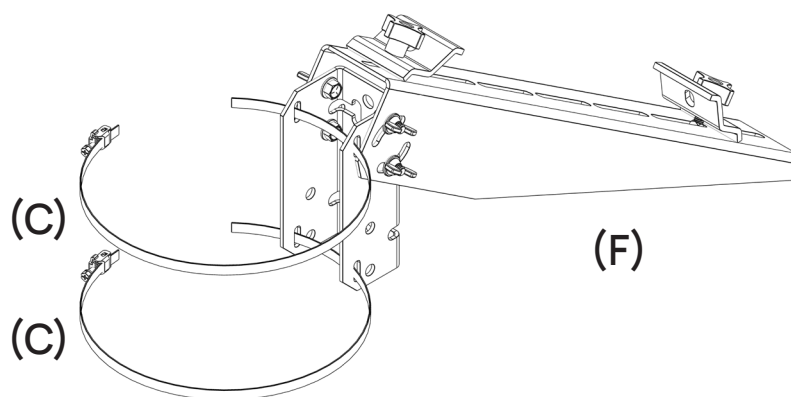

(See page 4 on how to use band clamps (C))

3C: ATTACH THE SOLAR PANELS TO THE SOLAR ARMS

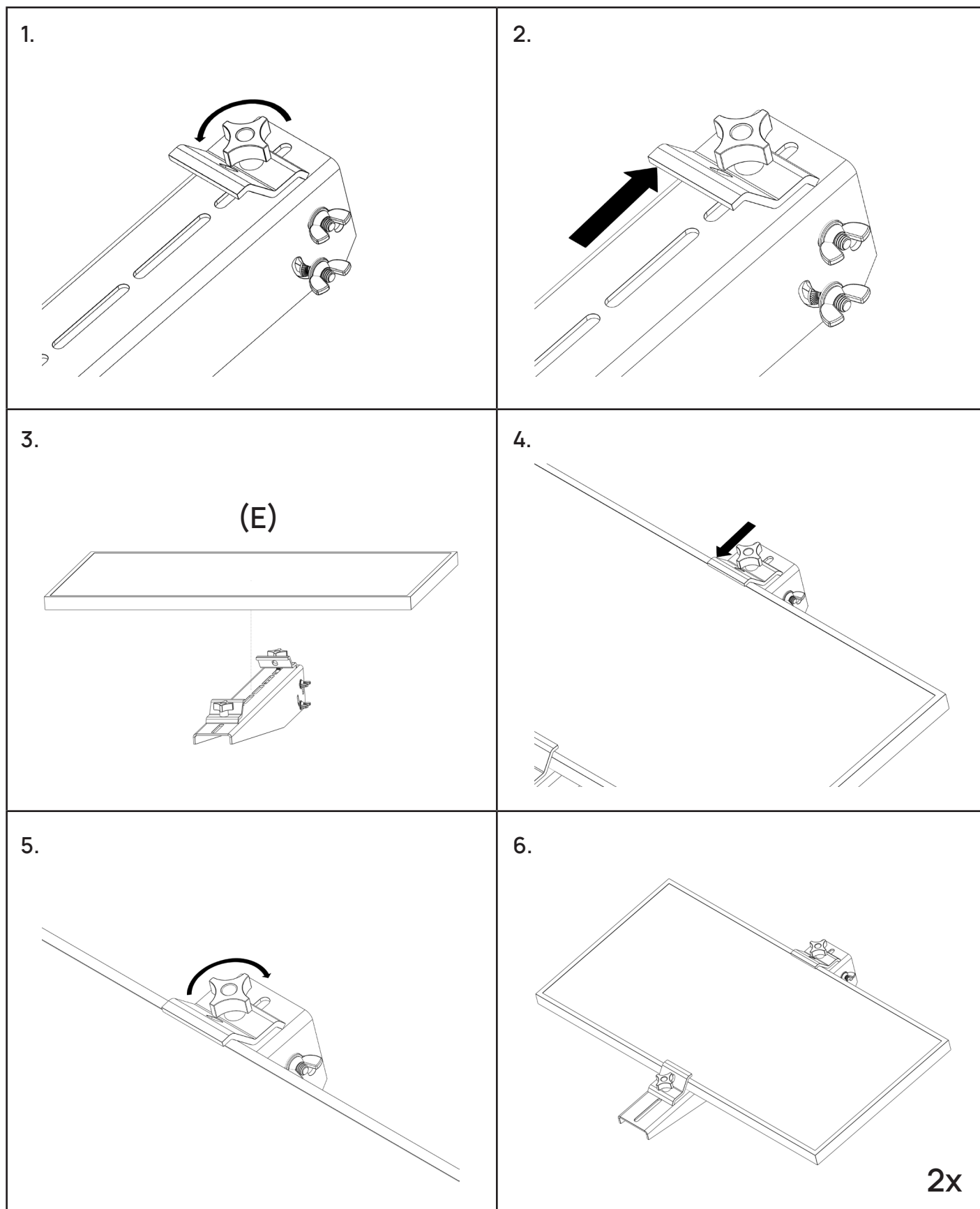

3D: ADJUST THE ANGLE OF THE SOLAR ARMS

Set the solar panels at the recommended angle for optimal sun exposure using the wing nuts.

This angle will vary based on your geographic location. Both solar panels should face the same direction and should be set at the same angle.

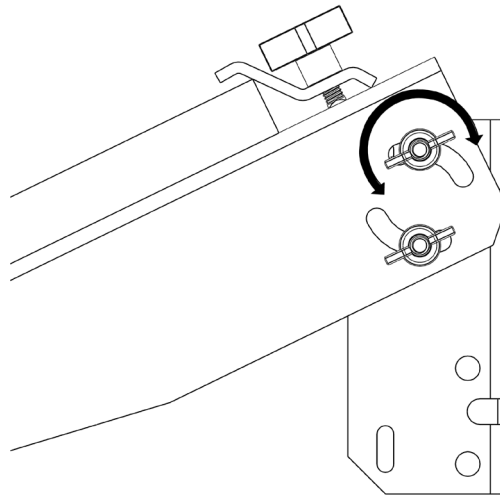

SenserAlign: Scan the QR code to download SenserAlign to help you properly position your solar panel. Available in the App Store and Google Play Store.



Northern USA, Canada

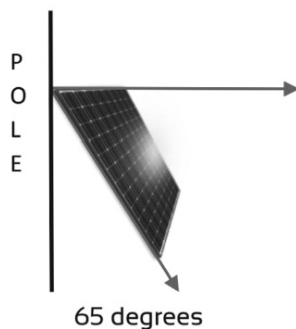

65 degrees

Central USA

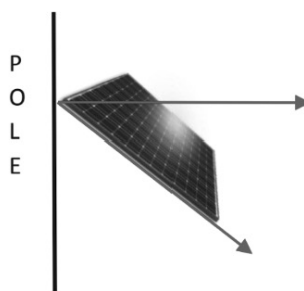

45 degrees

Southern USA

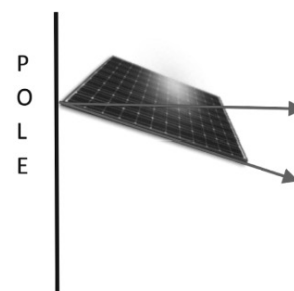

25 degrees

**If you are located outside of North America, please use the SenserAlign App for the correct angle*

STEP 4: CABLE CONNECTIONS & CONFIGURATION

1. The power port and PTZ camera port on the CPU are covered by weather-resistant caps. Remove the caps from the ports.
2. Insert the auxiliary solar or AC power cable to the power port. Note the keyed connector, which must be aligned during connection.
Please refer to the image below for an explanation of which ports are related to each function.
3. The power cable has a locking ring at the end. Twist the locking ring until you feel it click into place to secure the connection. The PTZ camera connection does not have a locking ring, and should be fastened tightly.
NOTE: Failure to tightly fasten all PTZ camera ethernet connections will render the PTZ camera non-functional.
4. Connect the main solar panel to the shorter connector on the auxiliary solar panel. Note the keyed connector which must be aligned during connection.

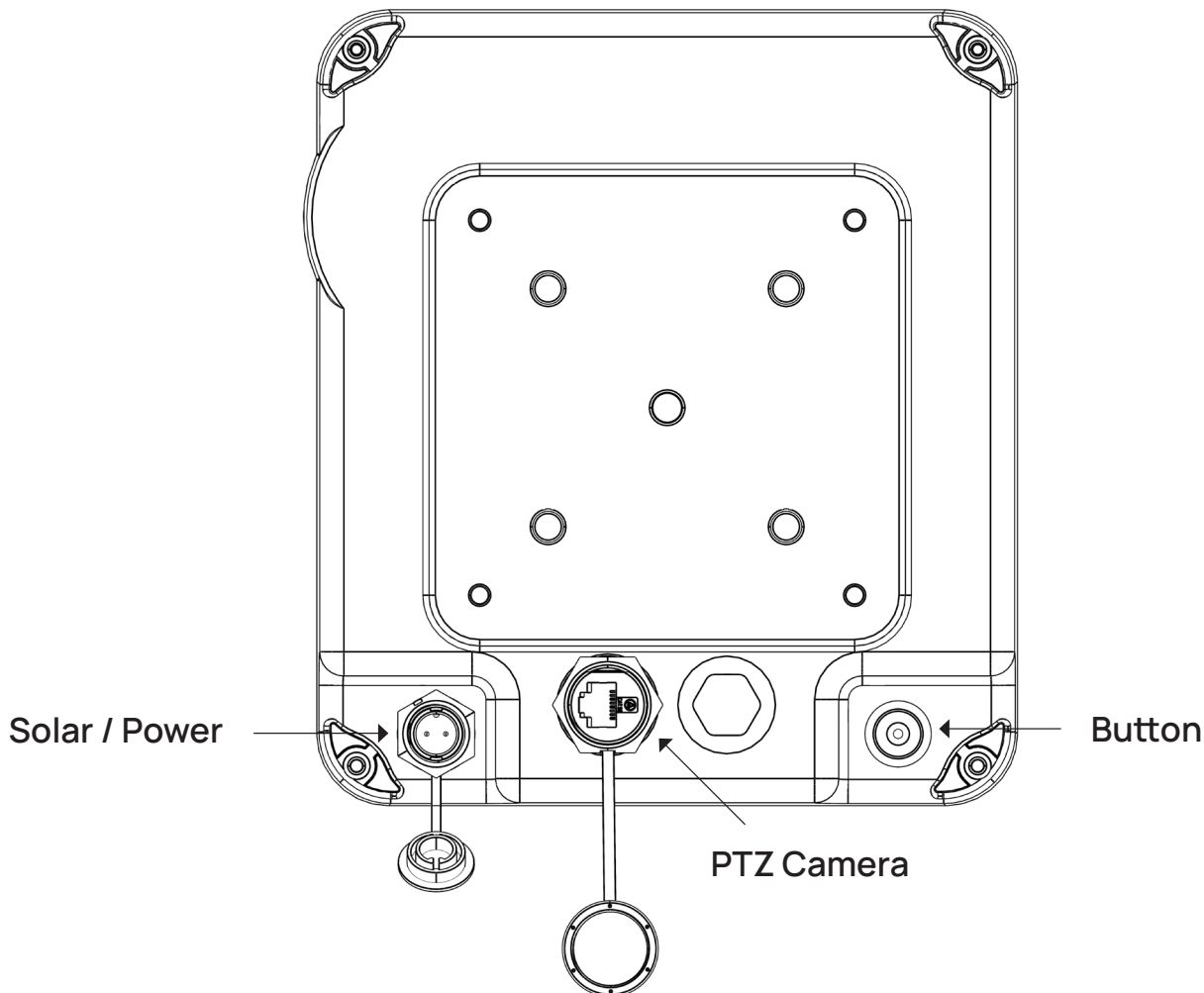

FINAL CHECKLIST

- ☐ Cross check camera placement with Sensera Systems Site Plan
- ☐ Take an on demand picture in SiteCloud to verify field of view
- ☐ Double check all cable connections and their locking mechanism
- ☐ Keep a copy of your serial numbers, locations, and the type of accessories each camera has for future reference
- ☐ Keep your indoor AC charger in a secure location
- ☐ Schedule an onboarding session with Sensera Systems Customer Support

REMINDER: Hardware is provided for multiple mounting solutions and there will be extra components at the end of installation.

Limited Warranty

July 1st, 2021

1. LIMITED PRODUCT WARRANTY

11.1 WHAT IS COVERED

This limited warranty covers defects in materials and workmanship in Products.

11.2 WHAT IS NOT COVERED

This limited warranty does not cover any damage, deterioration, or malfunction resulting from any alteration, modification, tampering, improper or unreasonable use or maintenance, misuse, abuse, accident, neglect, exposure to extreme weather conditions, environmental conditions outside the specified ranges, fire, improper packing and shipping (such claims must be presented to the carrier), lightning, power surges, or other acts of nature or God.

11.3 HOW LONG THIS COVERAGE LASTS

This limited warranty with respect to any purchased Products lasts three (3) years from the original invoice date under which Buyer is billed for each such Product. This limited warranty for all rental Products lasts for the Rental Term applicable to each such Product.

11.4 WHO IS COVERED

If Buyer resells any Products, this limited warranty does not transfer to the new owner upon resale.

11.5 WHAT SENSERA WILL DO UNDER THIS LIMITED WARRANTY SENSERA will, at its sole option, provide one of the following two remedies to satisfy a proper claim under this limited warranty:

1. Elect to repair any defective Products within a reasonable period of time, free of any charge for the necessary parts and labor to repair the Products to their proper operating condition.
2. Replace the defective Products with, at its sole option, new or refurbished replacement Products or with similar Products deemed by SENSERA to perform substantially the same function as the original Products.

Products that Buyer purchased that are repaired or replaced under this limited warranty will be warranted for the remainder of the original warranty period or ninety (90) days, whichever is longer. Products that Buyer rents that are repaired or replaced under this limited warranty will be warranted for the remainder of the original warranty period.

11.6 WHAT SENSERA WILL NOT DO UNDER THIS LIMITED WARRANTY SENSERA will not be responsible for any costs related to the removal or return of the Products. SENSERA will not be responsible for any costs related to any re-installation of the Products or any adjustment of User controls or any programming required during any re-installation of the Products.

11.7 HOW TO OBTAIN A REMEDY UNDER THIS LIMITED WARRANTY To obtain a remedy under this limited warranty, Buyer must contact SENSERA Customer Support at 800-657-0437 or support@senserasytems.com. Buyer must provide the serial number for the affected Product and the original invoice under which the defective Product was purchased as proof of purchase. If a Product is to be returned for repair or replacement, a return authorization number ("RMA Number") is required and will be provided to Buyer. Buyer will securely package the returned Product in a carton bearing the associated RMA Number. If a replacement Product is provided and SENSERA does not receive the defective Product to be returned under this limited warranty within fourteen (14) days of SENSERA providing the RMA Number to Buyer, SENSERA reserves the right to invoice, and Buyer will promptly pay, as applicable, (i) a late return fee owing for the period following the fourteen (14) day return window and the date on which SENSERA actually receives the returned Product, or (ii) a non-return fee, up to the then current published purchase price for the replacement Product, if Buyer never actually returns the defective Product.

11.8 OTHER CONDITIONS

This limited warranty is void vis-a-vis a certain Product if (a) the label bearing the serial number of the Product has been removed or defaced; or (b) the Product is not distributed by SENSERA.